

Notes:

1. All Dimensions are to scale
2. Location of signs to be confirmed by site management to ensure visibility.
3. All signs to be class A reflective or diamond grade.
4. All signs to be implemented to Australian standards and TCAWS when appropriate.
5. The TCP must be setup by qualified personnel holding "implement traffic Control Plans" card.
6. Pedestrian access to be maintained at all times.
7. All distances between signs to be in accordance with section 2.5.2 of AS1742.3:2009. However modifications may be made to suit site conditions.
8. Construction vehicle movements should be minimised during peak times.
9. Traffic controller and Prepare to Stop signs to be covered or removed when Traffic controllers not on site.
10. No queuing of trucks on public roads.
11. Vehicles and pedestrians already on the roadway or footpath have the right of way.

**Legend**

- Cone
- Crowd Control Barriers
- Light Rail
- Traffic Ute with Arrowboard

**TCP CPB - Pitt Street Station South - Temporary Road Closure Pitt Street - Crane Dismantle (Buildgroup)**

Crowd control barriers to be used ensuring separation from pedestrians to work area

All Pedestrian accesses to be maintained during the work. Footpaths along frontages of Pitt & Bathurst Street have Hoardings. Pedestrian traffic lights at intersection to remain operational

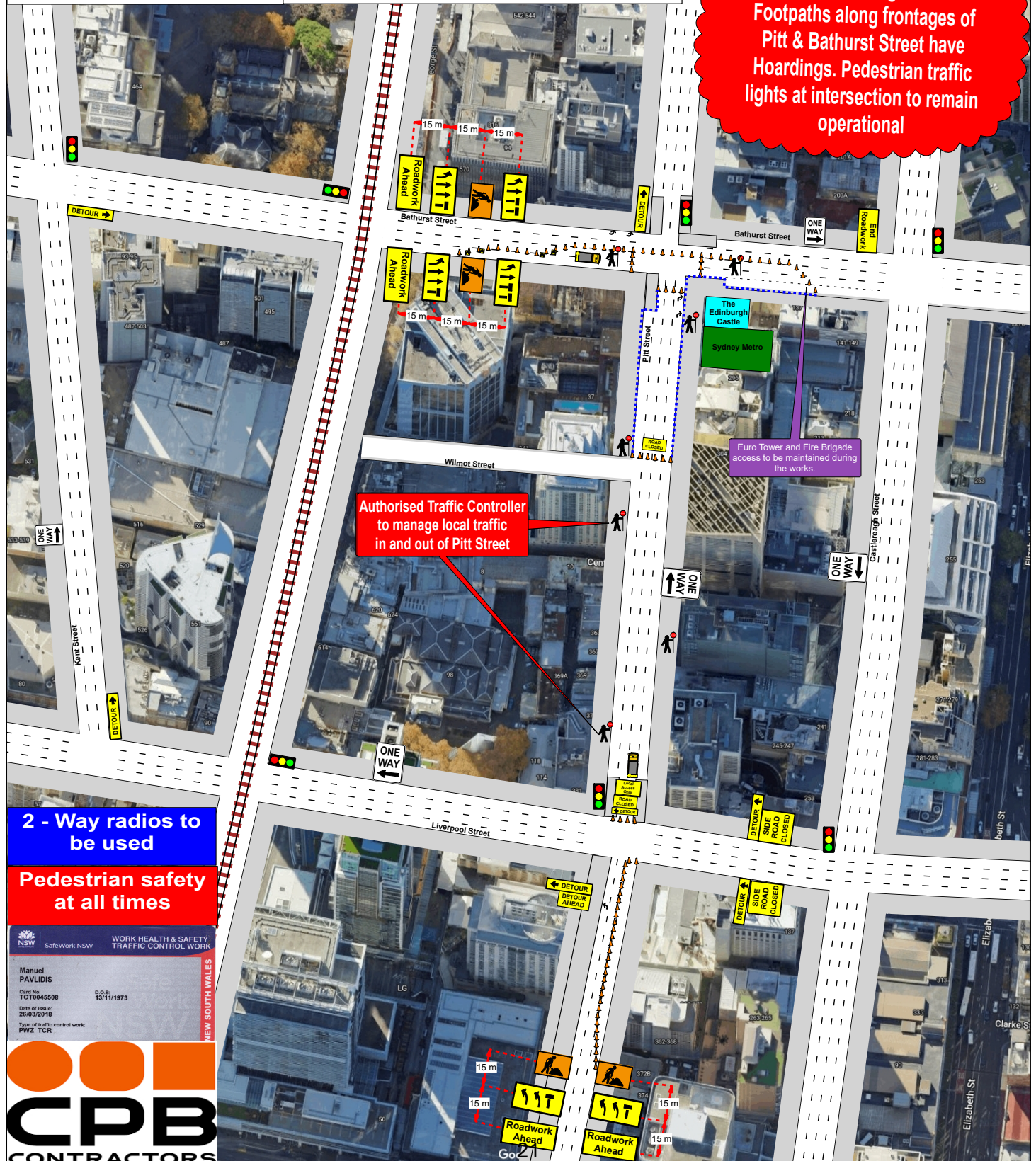

**2 - Way radios to be used**  
**Pedestrian safety at all times**

NSW SafeWork NSW WORK HEALTH & SAFETY TRAFFIC CONTROL WORK

Manuel PAVLIDIS  
 Client No: TCT0045508 O.C.B. 13/11/1973  
 Date of Issue: 26/03/2018  
 Type of traffic control work: PWZ TCR

NEW SOUTH WALES



Notes:

1. All Dimensions are to scale
2. Location of signs to be confirmed by site management to ensure visibility.
3. All signs to be class A reflective or diamond grade.
4. All signs to be implemented to Australian standards and TCAWS when appropriate.
5. The TCP must be setup by qualified personnel holding "implement traffic Control Plans" card.
6. Pedestrian access to be maintained at all times.
7. All distances between signs to be in accordance with section 2.5.2 of AS1742.3:2009. However modifications may be made to suit site conditions.
8. Construction vehicle movements should be minimised during peak times.
9. Traffic controller and Prepare to Stop signs to be covered or removed when Traffic controllers not on site.
10. No queuing of trucks on public roads.
11. Vehicles and pedestrians already on the roadway or footpath have the right of way.

**Legend**

- Cone
- Crowd Control Barriers
- Light Rail
- Traffic Ute with Arrowboard

**TCP CPB - Pitt Street Station South - Temporary Road Closure Pitt Street - Crane Dismantle (Buildgroup)**

Crowd control barriers to be used ensuring separation from pedestrians to work area

All Pedestrian acces to be maintained during the work. Footpaths along frontages of Pitt & Bathurst Street have Hoardings. Pedestrian traffic lights at intersection to remain operational

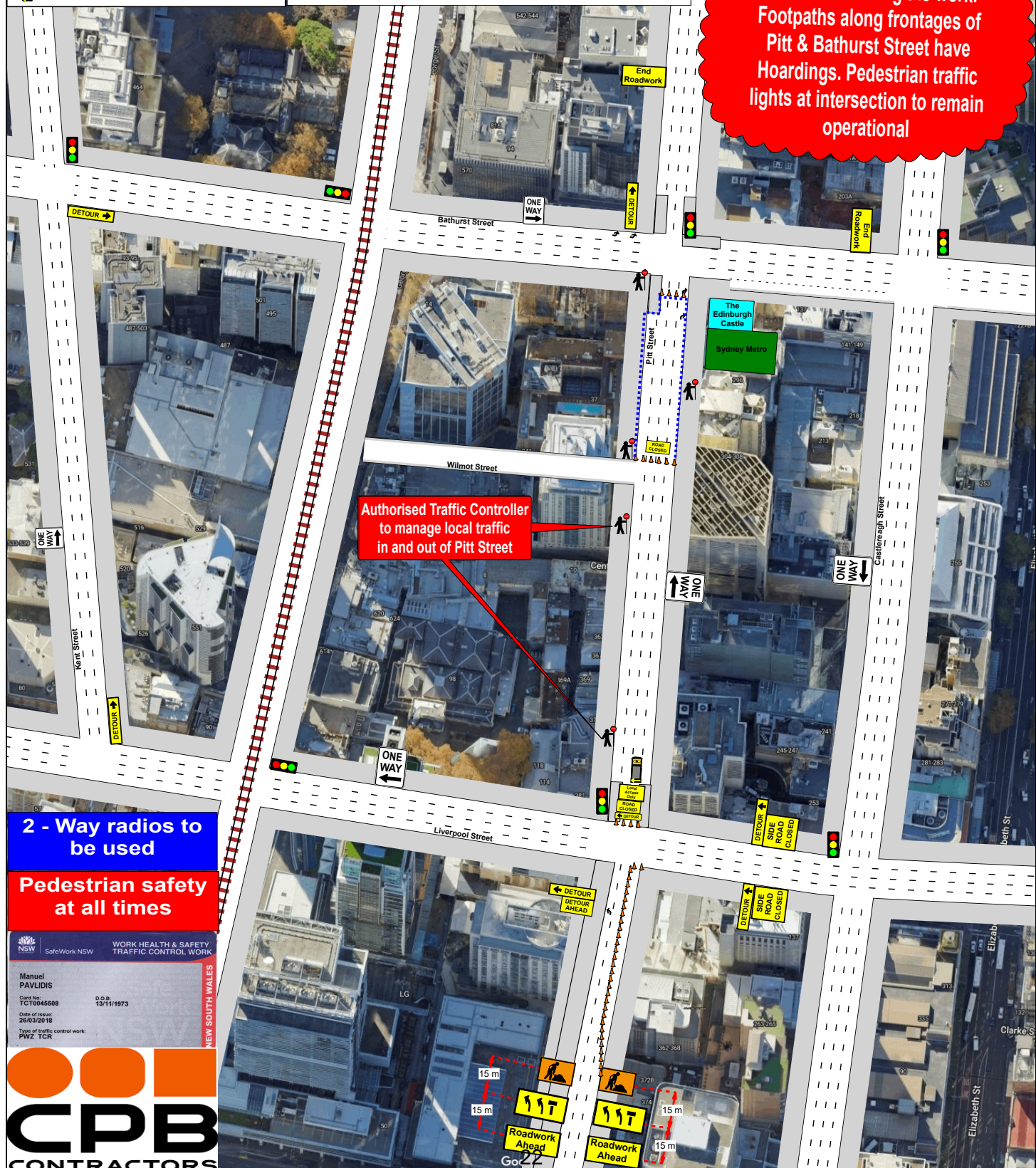

2 - Way radios to be used

Pedestrian safety at all times

NSW SafeWork NSW WORK HEALTH & SAFETY TRAFFIC CONTROL WORK

Manuel PAVLIDIS  
 Certificate: TC10045508  
 Date of Issue: 26/03/2018  
 Type of traffic control work: PWZ TCR